

xenta

www.xenta.co.uk



Xenta X-Force 1H

5.1 Surround Sound Home Theatre

Instruction Manual

IMPORTANT SAFETY INFORMATION

- Read these instructions carefully.
- Keep these instructions safe for later use.
- Unplug the speakers from the computer and from the electrical outlet before cleaning them with a dry cloth.
- Install in accordance with the manufacturer's instructions.
- Place the speakers in a stable location so they will not fall, causing damage to the speakers or bodily harm.
- Do not use the speakers near water, and do not immerse them in a liquid or pour any liquid on them.
- Do not block the openings in the speaker cabinets, never push objects in to speaker vents or slots because of fire or electric shock hazards and provide sufficient space around the speakers for proper ventilation.
- Do not install near any heat sources such as radiators, heat registers, stoves, or other apparatus (including amplifiers) that produce heat.
- Do not defeat the safety purpose of the polarized plug. A polarised plug has two blades with one wider than the other. The wide blade is provided for your safety. If the provided plug does not fit in to your outlet, consult an electrician for replacement of the obsolete outlet.
- Operate the speakers only from the low level audio line out jack of the computer or of an audio device.
- Protect the power cord from being walked on or pinched particularly at plugs, convenience receptacles and the point where they exit from the apparatus.
- Only use attachments/accessories specified by the manufacturer.
- For added protection during lightning storms, unplug the speakers from the electrical outlet and turn off the computer.
- Unplug this apparatus when unused for long periods of time.
- Servicing is required when the apparatus has been damaged in any way, such as when the power supply cord or plug has been damaged, liquid has been spilled or objects have fallen in to the apparatus, the apparatus has been exposed to rain or moisture, does not operate normally or has been dropped.
- Refer all servicing to qualified service personnel.
- The speakers should be disconnected from the mains by placing the power/standby switch in the standby position and unplugging the power cord of the speakers from the AC mains receptacle.
- Do not place any form of open flame source such as lighted candles on the apparatus.
- The socket-outlet shall be installed near the equipment and shall be readily accessible.

WARNING:

TO REDUCE THE RISK OF ELECTRIC SHOCK, DO NOT EXPOSE THIS APPARATUS TO RAIN OR MOISTURE!

BOX CONTENTS

- X5 Satellites
- X1 Subwoofer
- X3 RCA-Stereo Signal Line
- X1 Manual

PLACING SPEAKERS

SUBWOOFER

All stereo-encoded information is heard through the satellite speakers. The subwoofer contains no stereo imaging, and its sound is non-directional. As a result, the subwoofer doesn't have to be placed in any particular relationship to the satellites. However, placing the subwoofer on the floor close to the wall or room corner provides better base efficiency and optimum sound.

SATELLITE SPEAKERS

Arrange the front satellites to suit your listening tastes – from right next to the monitor to as far apart as the speaker cods allow. The rear satellites should be placed slightly behind you, or as far back at the cods allow. Place the centre satellite either on top or below the centre of the monitor. For optimum sound, all satellites should be placed at or slightly above ear level, and in an arrangement that offers the most satisfying results.

NOTE: All the satellite speakers are magnetically shielded and can be placed close to the video displays such as TV's and computer monitors without distorting the images.

CONNECTING

WARNING:

Do not insert the speaker systems plug in to an outlet until all connections are made. Also, turn off audio source before connecting the outputs to this systems inputs.

To ensure first-time operation as expected, carefully follow the connection sequences described below in the order indicated for your particular application.

Setup is fast and easy: simply connect the audio source inputs and the satellite speakers to the rear of the subwoofer.

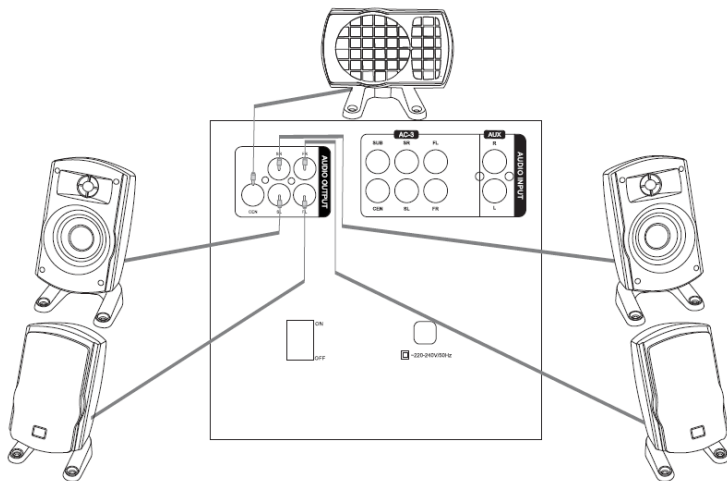

INPUTS

Various connection schemes between your audio source and this system are available. Determine if you'll be setting up the speaker system for PC audio/PC gaming, DVD playback, console gaming or with portable audio devices (such as MP3), then skip to the appropriate section.

1-CHANNEL / TV SET / VCD PLAYER

1. Locate a signal cable with an RCA-RCA jack (not included)
2. Insert the RCA jack with the AUX / CD / VCD input outlet on the subwoofer.
3. Connect another end of the signal cable with the audio devices output.
4. Select "AUX" input on the remote control when it's powered on.

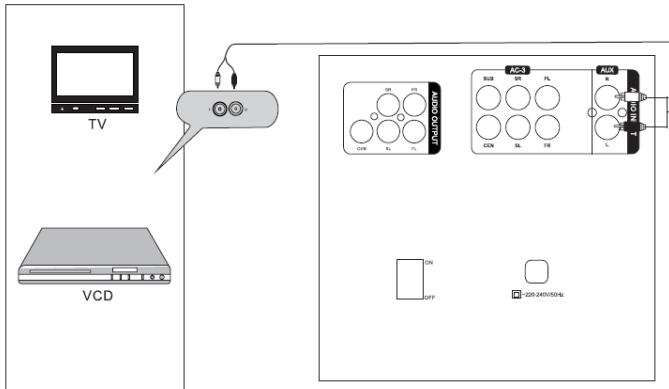

2-CHANNEL / STEREO SOUND CARDS

1. Locate a signal cable with an STEREO-RCA jack.
2. Insert the RCA jack with the input outlet on the subwoofer.
3. Connect another end of the signal cable with the audio devices output.
4. Select “AUX” input on the remote control when it’s powered on.

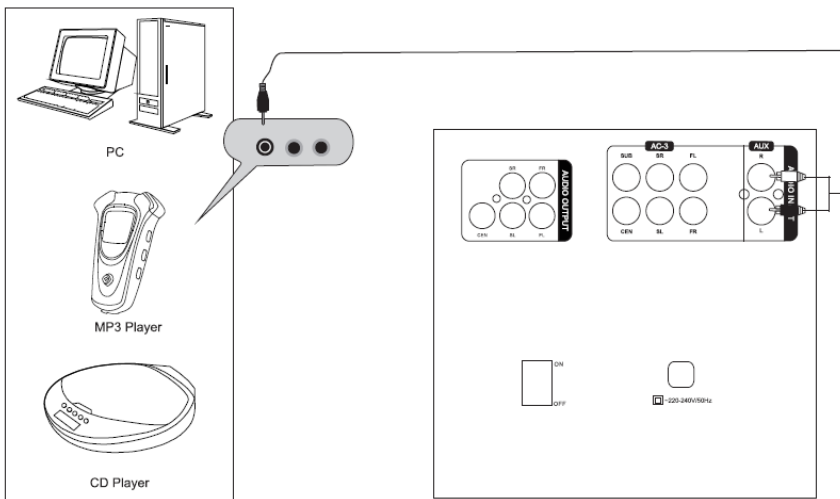

3-CHANNEL / 5.1 SOUND CARDS

1. Locate the 3 pieces of signal cable with RCA-stereo jack.
2. Insert the RCA jack with the AC/3 input outlet on the subwoofer.
3. Connect another end of the signal cable with the audio devices output.
4. Select “AC-3” input on the remote control when it’s powered on.

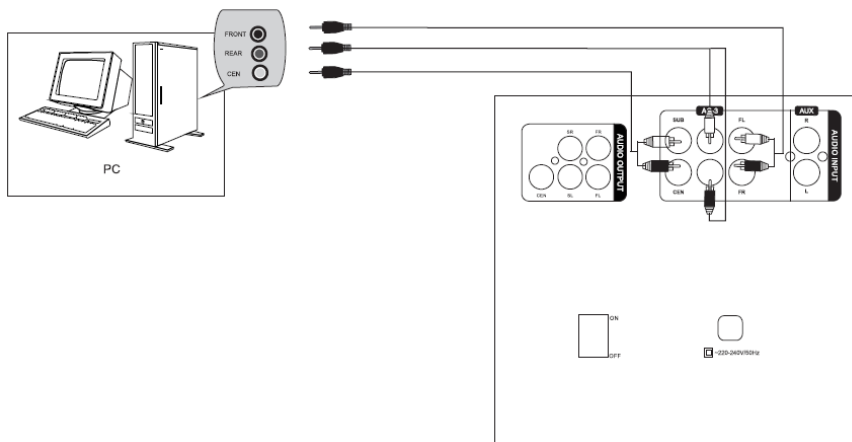

4-CHANNEL / 5.1 DVD PLAYERS

1. Locate the 3 pieces of signal cable with RCA-RCA jack (not included).
2. Insert the RCA jack with the AC/3 input outlet on the subwoofer.
3. Connect another end of the signal cable with the audio devices output.
4. Select “AC-3” input on the remote control when it’s powered on.

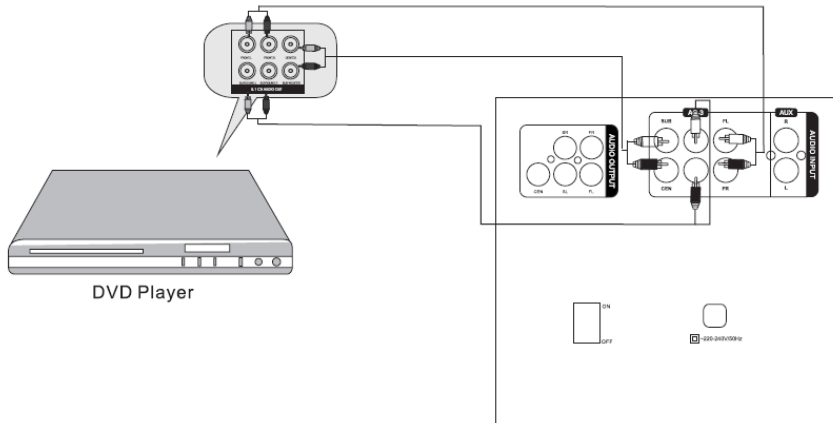

POWERING ON

1. After all other connections are made, plug the AC power cord (on the back of the subwoofer) in to a wall outlet. The speaker system is now ready to operate.
2. Turn on the audio source.
3. Turn on the speaker system by pushing the on/off button located on the back of the subwoofer. An LED will light on when the power is on.

NOTE: To avoid hearing a popping sound when you turn on the speaker system, always turn on your audio source first.

USING THE SYSTEM

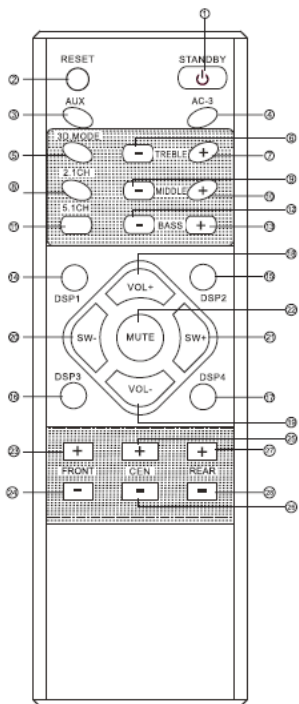

1. Standby
2. Reset
3. AUX
4. AC-3
5. 3D Mode
6. Treble Down
7. Treble Up
8. 2.1 Ch. Output
9. Middle Down
10. Middle Up
11. Simulated 5.1 Ch. Output
12. Bass -
13. Bass +
14. Sound Field Effort 1
15. Sound Field Effort 2
16. Sound Field Effort 3
17. Sound Field Effort 4
18. Main Volume Up
19. Main Volume Down
20. Subwoofer Volume Down
21. Subwoofer Volume Up
22. Mute
23. Front Volume Up
24. Front Volume Down
25. Center Volume Up
26. Center Volume Down
27. Rear Volume Up
28. Rear Volume Down

Adjustment of Sound Level: Press these buttons to get your satisfied sound level.

Vol + / Vol –

Cen + / Cen –

Rear + / Rear –

Sub + / Sub –

Adjustment of Sound Tone: Press these buttons to get your satisfied sound level.

Treble + / Treble –

Bass + / Bass –

Middle + / Middle –

Simulated 5.1 Sound Function:

Press “5.1 Ch.” To get simulated 5.1 surrounding when you are playing stereo audio source.

Press “2.1 Ch.” To return to 2.1 stereo playback

Mute Function: To minimise the sound by the most convenient way.

3D Mode: Enjoy 3D sound field when you are playing stereo audio.

Reset: To return to default factory setup.

SPECIFICATIONS

TOTAL RMS POWER	80W
SUBWOOFER	30W RMS into 4ohms at 100Hz at 10% THD (Total Harmonic Distortion)
SATELLITES	50W RMS into 4ohms at 1kHz at 10% THD (Total Harmonic Distortion)
TOTAL PEAK POWER	160W at < 10% THD
SYSTEM THD	Better than 0.05% THD before clipping
SIGNAL TO NOISE RATIO	>96dB
FREQUENCY RESPONSE	20Hz – 20kHz
DRIVER SIZE	3" + 1" High Excursion Satellites 5.25" High Excursion Subwoofer
SPEAKER DIMENSIONS:	
SATELLITES	100W x 105D x 180H (mm)
SUBWOOFER	230W x 255D x 210H (mm)
POWERS SUPPLY	220V – 240V AC 50Hz

